

New opening to be formed in blockwork wall between lounge and new kitchen with load propped and supported as per engineer's drawings. New lintels to be installed as per engineer's spec.

New kitchen to be installed in former lounge with all drainage connecting back to existing

Existing windows to be removed and wall infilled to side to allow for kitchen installation and new french doors to decking area. Existing lintel to remain

Existing window to be removed and wall opened up with lintel fitted in line with engineer's spec. New BiFold doors to be added from family room to decking

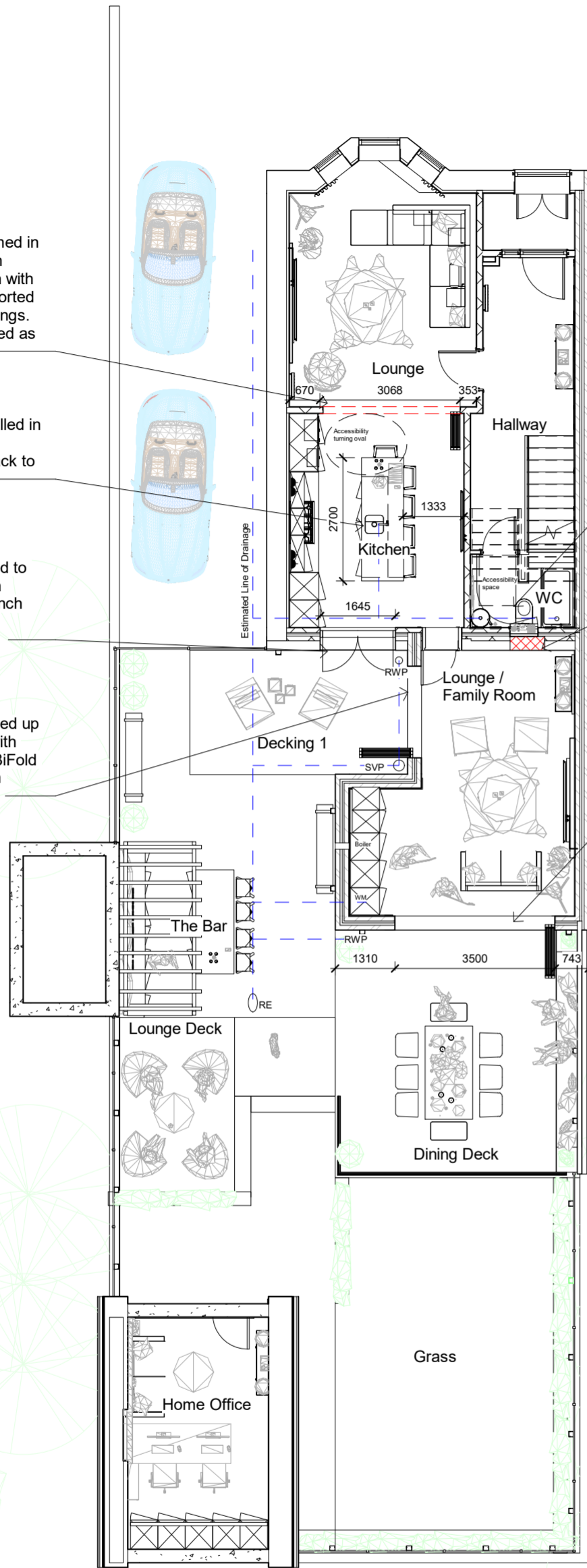

### Proposed GF Plan

1 : 100



External View 1



External View 2



Internal View 3

New opening to be formed in hallway wall to allow for new GF shower room to be formed under stairs. Extract to be ducted to outside under suspended floor.

Existing doorway to be removed and infilled to new family room side with recess for WC cistern.

New opening to be formed with lintels installed as per engineer's specification to new family room to allow for installation of new slide and fold doors to rear decked area.

NO	DESCRIPTION	DATE
STATUS	PURPOSE OF ISSUE	

**Belle Unique Ltd**  
 59 Main Street, Kilsyth,  
 Glasgow, G65 0AH  
 t: 01236 827 509  
 e: design@belle-unique.co.uk  
 w: www.belle-unique.co.uk



Project **Internal Restructuring**

Title **Proposed Plan**

Client

DRAWN BY Author	CHECKED BY Checker	DATE 16.11.21
SCALE ( @A2 ) 1 : 100		PROJECT NUMBER 108/21
DRAWING NUMBER 102		REV